

YUE-KONG PAO HALL OF VISUAL AND PERFORMING ARTS



PURDUE UNIVERSITY
WEST LAFAYETTE ▪ INDIANA ▪ USA

YUE-KONG PAO HALL
PURDUE UNIVERSITY
WEST LAFAYETTE ▪ INDIANA ▪ USA

■ BUILDING DESCRIPTION

Named for Chinese shipping magnate, the late Sir Yue-Kong Pao, Yue-Kong Pao Hall of Visual and Performing Arts is a \$47 million, 176,000 square-foot facility that brings the four Divisions [Art and Design, Dance, Music, and Theatre] of the Patti and Rusty Rueff Department of Visual and Performing Arts under one roof for the first time since the formation of the Department in 1966. These academic programs had been spread across campus in nine separate buildings prior to the completion of this facility.

The Division of Theatre occupies two performance venues in Pao Hall: The Nancy T. Hansen Theatre, a 300-seat proscenium space; and, The Carole and Gordon Mallett Theatre, a 100 to 155-seat flexible venue. In addition, the Division's classrooms, offices, shops and studios are included in the facility.

The inaugural production in each of the two theatres was given during spring semester of 2006.

YUE-KONG PAO HALL
PURDUE UNIVERSITY
WEST LAFAYETTE ▪ INDIANA ▪ USA

■ **BUILDING PROGRAM SUMMARY**

GROSS BUILDING AREA **176,213 square feet**

TOTAL THEATRE AREA (see below) **51,663 square feet**

NANCY T. HANSEN THEATRE (Seating for 300)

STAGE TRAP AND ORCHESTRA 1,435 sq. ft.

AUDITORIUM AND STAGE 8,383 sq. ft.

UPPER SEATING AND LIGHTING CONTROL 7,454 sq. ft.

LIGHTING CONTROL AND TECHNICAL PLATFORM 983 sq. ft.

FLY GALLERY AND PLATFORMS 2,840 sq. ft.

SUBTOTAL: **21,095 sq. ft.**

CAROLE AND GORDON MALLETT THEATRE (Seating for 100-155)

SEATING AND STAGE AREA 3,370 sq. ft.

TECHNICAL SOUND & LIGHTING CONTROL 3,365 sq. ft.

SUBTOTAL **6,735 sq. ft.**

YUE-KONG PAO HALL
PURDUE UNIVERSITY
WEST LAFAYETTE ▪ INDIANA ▪ USA

■ BUILDING PROGRAM SUMMARY, continued

THEATRE SUPPORT AND EDUCATIONAL SPACES

AUDIO RECORDING STUDIO	910 sq. ft
RECORDING CONTROL ROOM	750 sq. ft
MUSIC COMPUTER LAB	953 sq. ft
THEATRE DESIGN LAB	910 sq. ft
LIGHTING DESIGN LAB	325 sq. ft
COSTUME AND EQUIPMENT STORAGE	1,592 sq. ft
LIGHTING AND PROP STORAGE	789 sq. ft
DRESSING ROOMS	1,876 sq. ft
GREEN ROOM	400 sq. ft
SCENERY CONSTRUCTION LAB AND LOADING DOCK	4,288 sq. ft
COSTUME CONSTRUCTION LAB	2,250 sq. ft
ACTING LABS	2,815 sq. ft
OFFICES	<u>5,975</u> sq. ft
SUBTOTAL	23,833 sq. ft.

YUE-KONG PAO HALL PURDUE UNIVERSITY WEST LAFAYETTE ▪ INDIANA ▪ USA

■ SITE PLAN

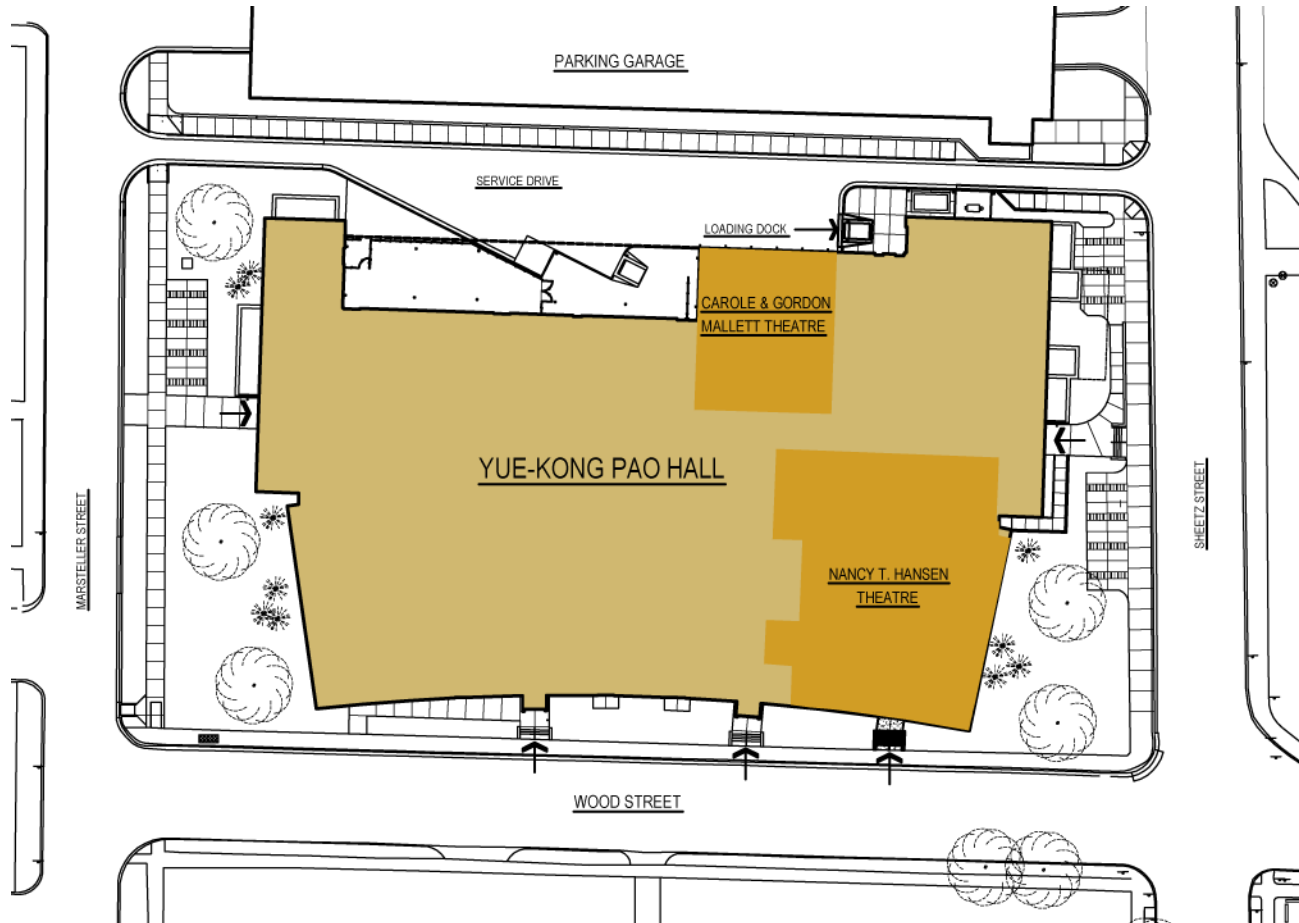

YUE-KONG PAO HALL PURDUE UNIVERSITY WEST LAFAYETTE ▪ INDIANA ▪ USA

■ LOWER LEVEL COMPOSITE PLAN



YUE-KONG PAO HALL PURDUE UNIVERSITY WEST LAFAYETTE ▪ INDIANA ▪ USA

■ LOWER LEVEL THEATRE SUPPORT SPACES



Audio Recording Studio

Photo by Jon Denker, CAPS



Recording Control Room

Photo by Jon Denker, CAPS



Music Computer Lab

Photo by Jon Denker, CAPS

YUE-KONG PAO HALL PURDUE UNIVERSITY WEST LAFAYETTE ▪ INDIANA ▪ USA

■ FIRST LEVEL COMPOSITE PLAN

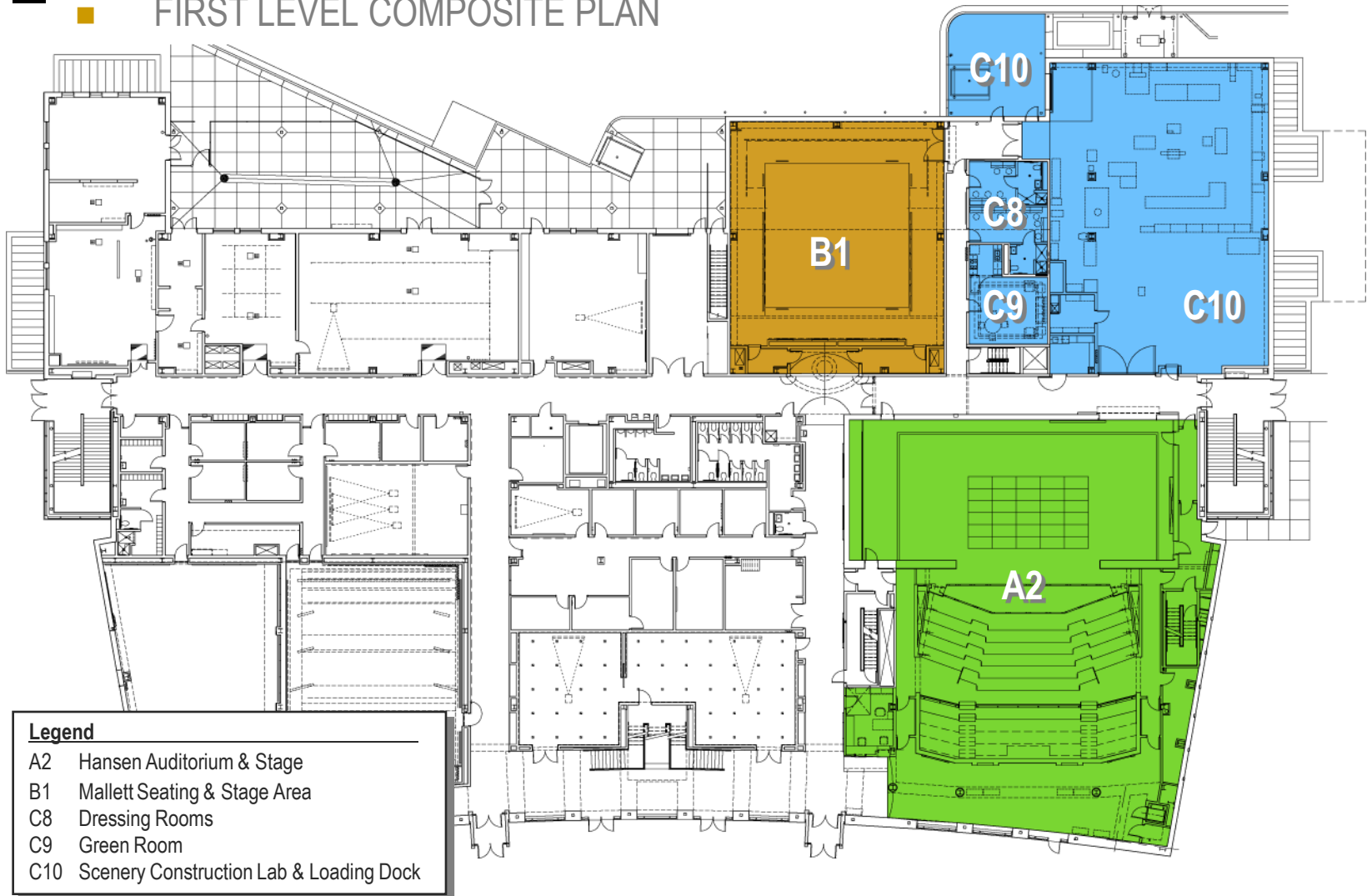

YUE-KONG PAO HALL PURDUE UNIVERSITY WEST LAFAYETTE ▪ INDIANA ▪ USA

- FIRST LEVEL THEATRE SUPPORT SPACES



Scenery Construction Lab

Photo by Jon Denker, CAPS



Loading Door to Hansen Stage

Photo by Jon Denker, CAPS

YUE-KONG PAO HALL PURDUE UNIVERSITY WEST LAFAYETTE ▪ INDIANA ▪ USA

■ SECOND LEVEL COMPOSITE PLAN



YUE-KONG PAO HALL PURDUE UNIVERSITY WEST LAFAYETTE ▪ INDIANA ▪ USA

■ SECOND LEVEL THEATRE SUPPORT SPACES



Lighting Design Lab
Photo by Jon Denker, CAPS



Costume Construction Lab
Photo by Jon Denker, CAPS

YUE-KONG PAO HALL PURDUE UNIVERSITY WEST LAFAYETTE ▪ INDIANA ▪ USA

■ THIRD LEVEL COMPOSITE PLAN



Legend

A5 Fly Gallery & Platforms

YUE-KONG PAO HALL PURDUE UNIVERSITY WEST LAFAYETTE ▪ INDIANA ▪ USA

■ FOURTH LEVEL COMPOSITE PLAN

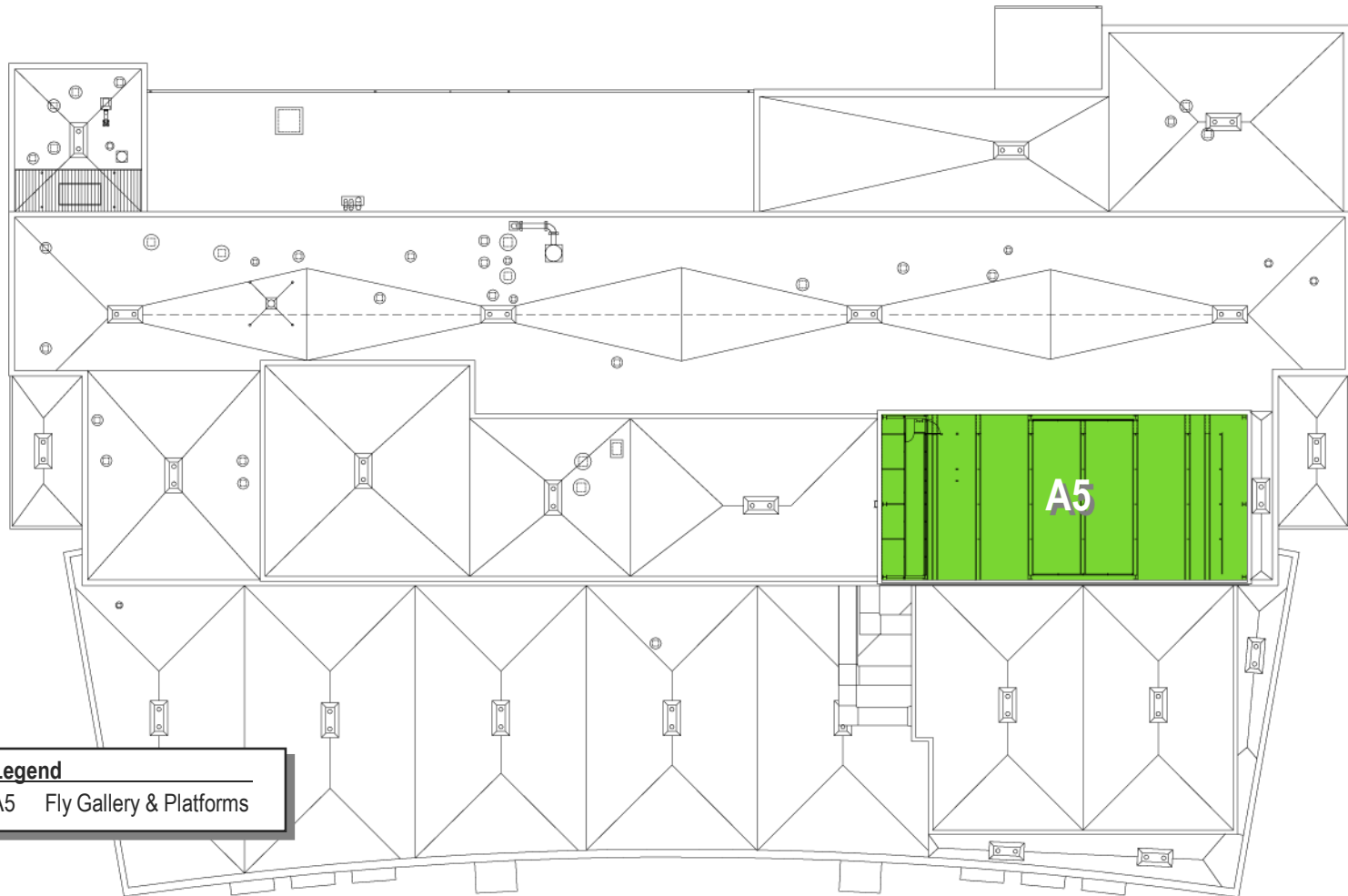

Legend

A5 Fly Gallery & Platforms

YUE-KONG PAO HALL PURDUE UNIVERSITY WEST LAFAYETTE ▪ INDIANA ▪ USA

■ NANCY T. HANSEN THEATRE: First Level Lobby Seating Plan

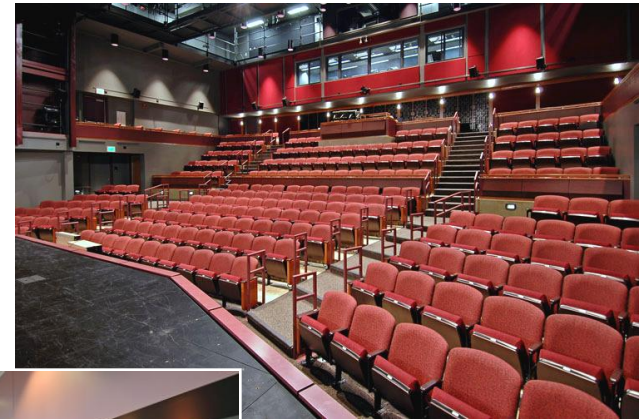
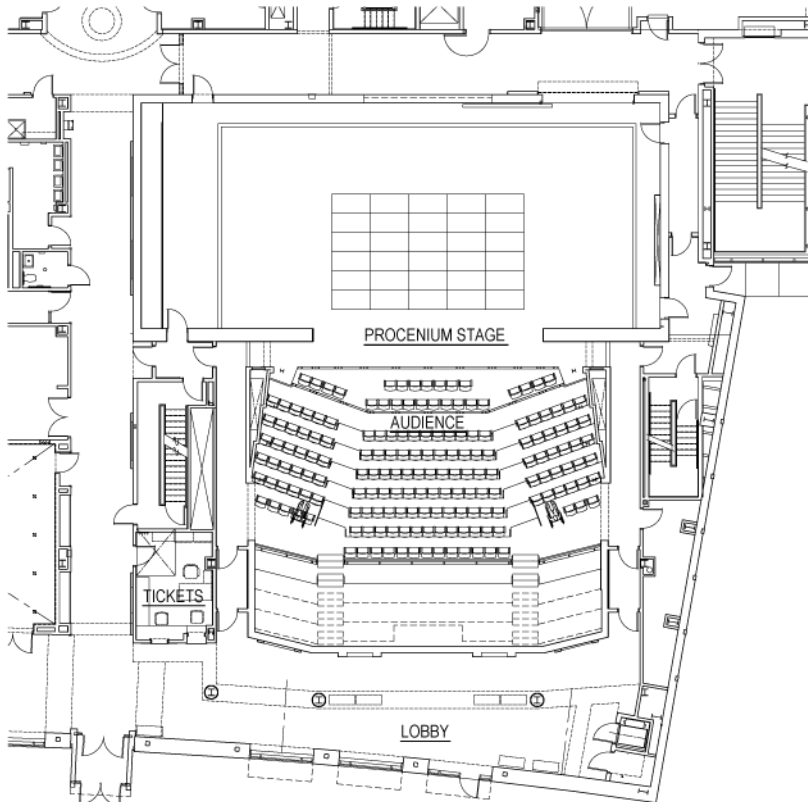

Auditorium Seating
Photo by Jon Denker, CAPS



Dorothy Runk Mennen Lobby
Photo by Jon Denker, CAPS

YUE-KONG PAO HALL PURDUE UNIVERSITY WEST LAFAYETTE ▪ INDIANA ▪ USA

■ NANCY T. HANSEN THEATRE: Upper Seating Plan

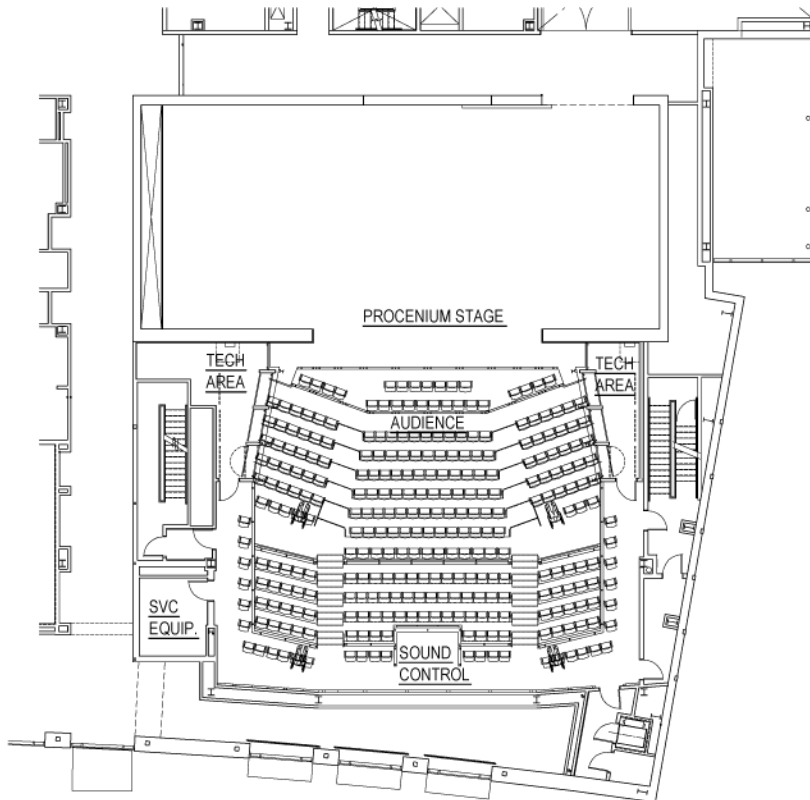

View from upper gallery seating

Photo by Jon Denker, CAPS



View from catwalk level toward audio control

Photo by Jon Denker, CAPS

YUE-KONG PAO HALL PURDUE UNIVERSITY WEST LAFAYETTE ▪ INDIANA ▪ USA

■ NANCY T. HANSEN THEATRE: Gallery Level Plan

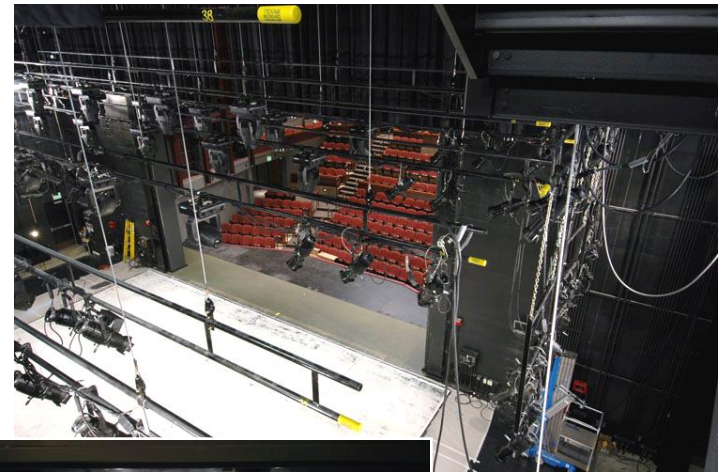
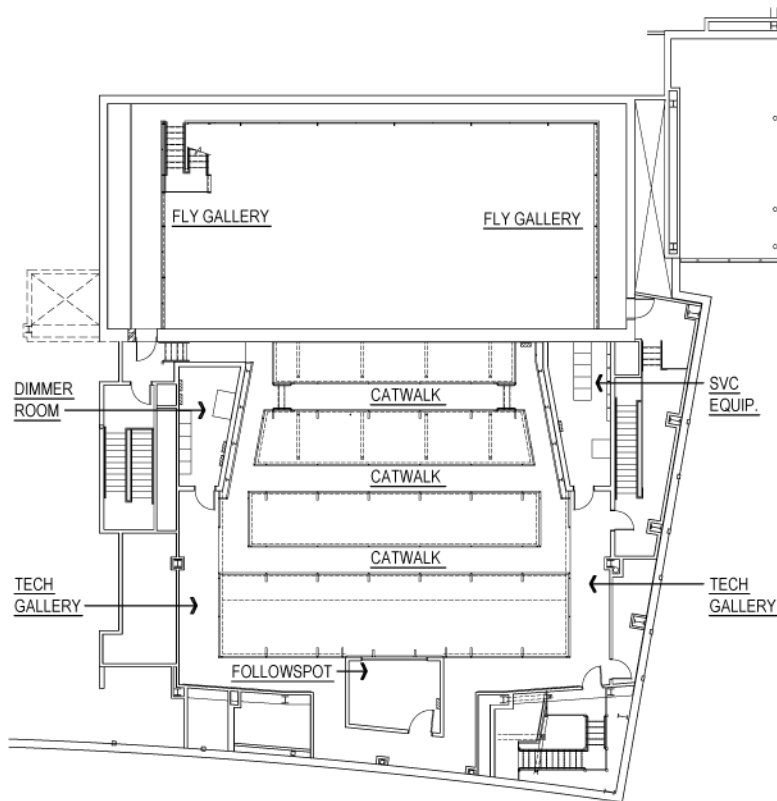

View toward stage
from fly gallery
Photo by Jon Denker, CAPS

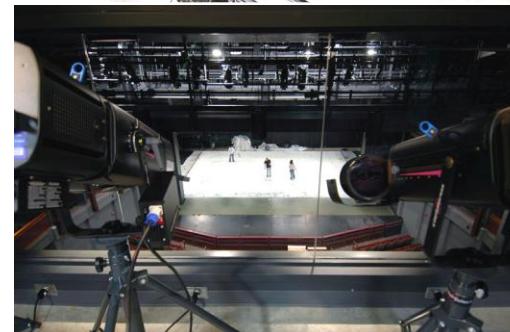

View toward stage from follow spot booth
Photo by Jon Denker, CAPS

YUE-KONG PAO HALL PURDUE UNIVERSITY WEST LAFAYETTE ▪ INDIANA ▪ USA

■ NANCY T. HANSEN THEATRE: Longitudinal Section

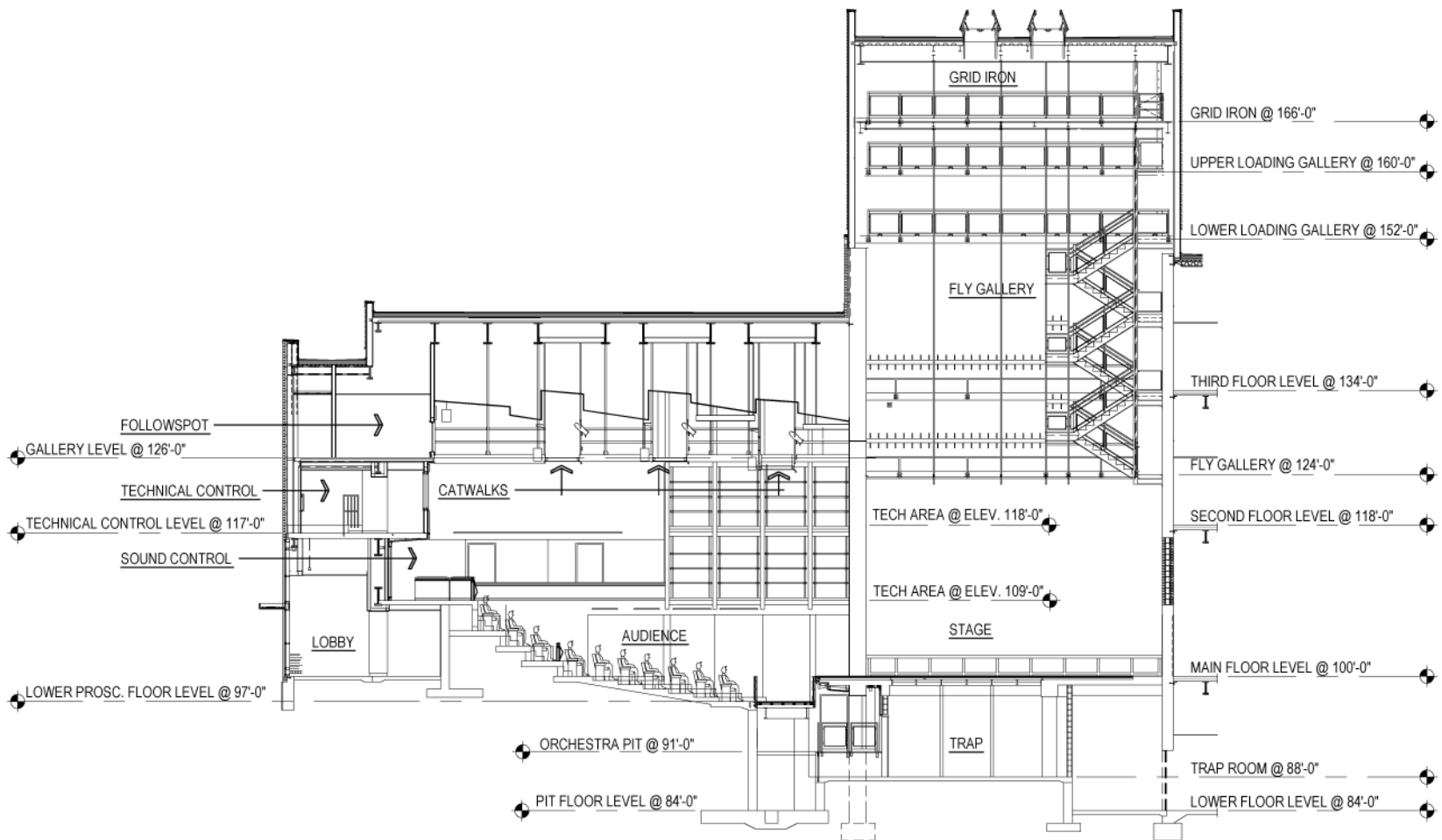

YUE-KONG PAO HALL
PURDUE UNIVERSITY
WEST LAFAYETTE ▪ INDIANA ▪ USA

- NANCY T. HANSEN THEATRE



View from Stage Across Auditorium

Photo by Jon Denker, CAPS

YUE-KONG PAO HALL PURDUE UNIVERSITY WEST LAFAYETTE ▪ INDIANA ▪ USA

■ CAROLE AND GORDON MALLET THEATRE: Floor Plans & Lateral Section View

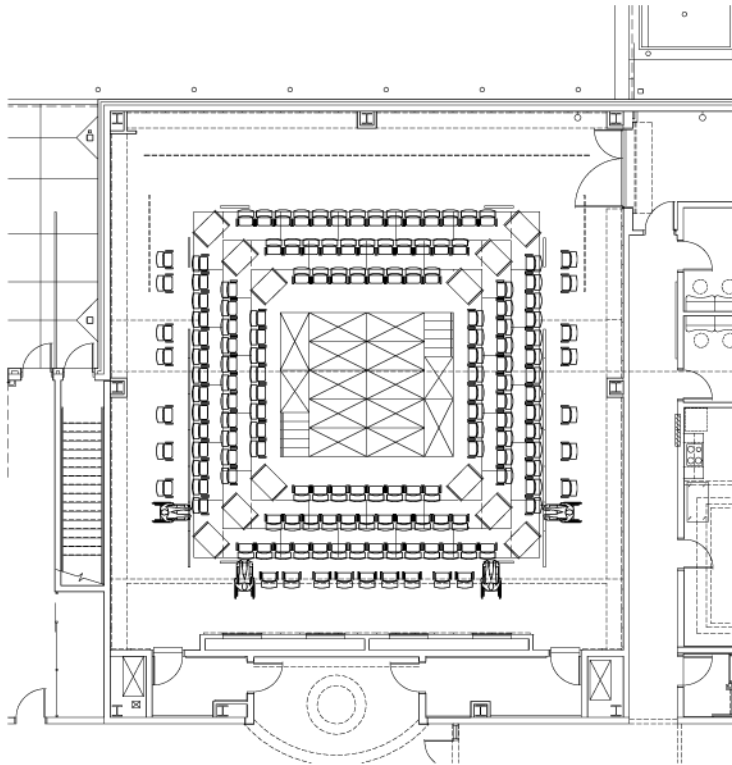

Center Stage Seating

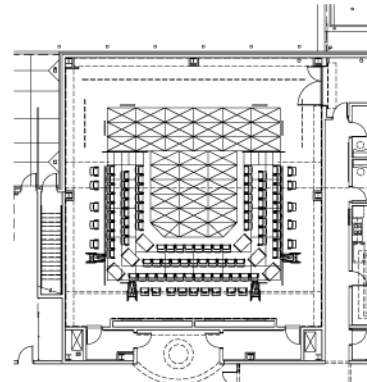

Thrust Seating

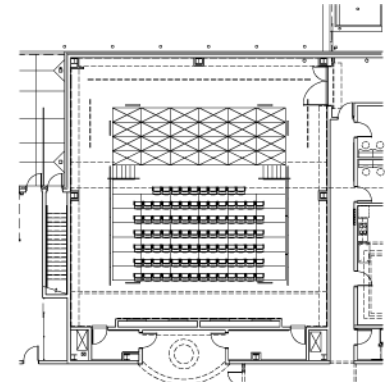

Endstage Seating

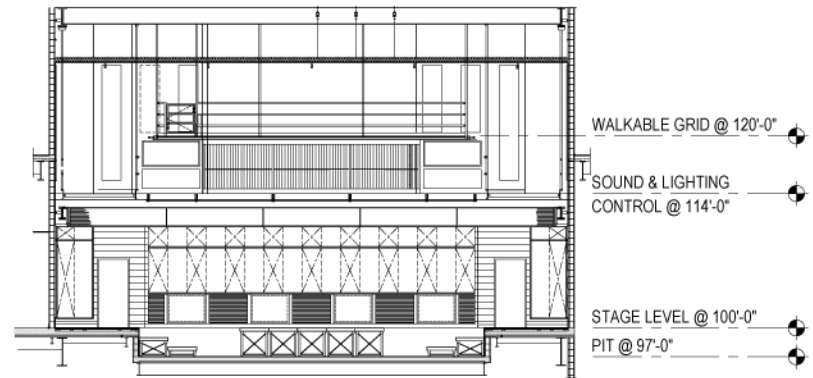

Lateral Section

WALKABLE GRID @ 120'-0"

SOUND & LIGHTING
CONTROL @ 114'-0"

STAGE LEVEL @ 100'-0"

PIT @ 97'-0"

YUE-KONG PAO HALL PURDUE UNIVERSITY WEST LAFAYETTE ▪ INDIANA ▪ USA

■ CAROLE AND GORDON MALLETT THEATRE



Lobby

Photo by Jon Denker, CAPS



Thrust staging in progress, viewed from west technical gallery

Tension wire grid overhead

Photo by Jon Denker, CAPS



Technical gallery

Photo by Jon Denker, CAPS